



Platypus

Submersible Pumps

INSTRUCTION MANUAL

2018 v1.0



MODELS

PP10LV · PP25LV · PP40LV · PP12 · PP25 · PP40 · PP65 · PP85 · PP110 · PP30 · PP60

CONGRATULATIONS ON YOUR PURCHASE OF THIS PRODUCT BY PLATYPUS.

TECHNICAL SPECIFICATIONS

DESCRIPTION	PP10LV	PP25LV	PP40LV	PP12	PP25	PP40	PP65	PP85	PP110	PP30	PP60
MAXIMUM FLOW (L/H)	1000	2400	3900	1200	2400	3900	6500	8500	11000	3000	6000
MAXIMUM HEAD (M)	1.95	2.40	2.95	1.30	2.40	2.95	5.00	7.00	6.20	2.50	3.50
POWER* (W)	20	35	70	25	50	85	140	170	170	35	95
VOLTS (V)	12	12	12	240	240	240	240	240	240	240	240
FREQUENCY(HZ)	50	50	50	50	50	50	50	50	50	50	50
OUTLET BSP	15	19	19	15	15	15	25	32	32	25	25
CABLE LENGTH (M)	10	10	10	10	10	10	10	10	10	10	10

* SUBJECT TO VARIATION ACCORDING TO LOAD.

PUMP FLOW RATE IN LITRES/HOUR

HEAD (M)

7.0							0				
6.5							900	0			
6.0							1400	1950			
5.5							2000	2850			
5.0						0	2300	3750			
4.5						1000	2800	4600			
4.0						1600	3400	5800			
3.5						2800	3900	6600			0
3.0			0		0	3000	4500	7100			780
2.5		0	1040		0	1040	3900	5100	7850	0	1920
2.0	0	600	1600		600	1660	4500	5800	8400	540	2700
1.5	350	1150	2000	0	1150	2000	5000	6500	9000	1080	3420
1.0	550	1600	2550	350	1160	2650	5500	7100	9700	1680	4380
0.5	850	2000	3250	1000	2000	3250	6000	7900	10600	2400	5100
0.0	1000	2400	3900	1200	2500	3900	6500	8500	11000	3000	6000
	PP10LV	PP25LV	PP40LV	PP12	PP25	PP40	PP65	PP85	PP110	PP30	PP60

SUBMERSIBLE PUMPS

INSTRUCTION MANUAL



IMPORTANT SAFEGUARDS

Please read the operating instructions and familiarize yourself with the equipment before placing it in service. Correct and safe use of the system requires strict compliance with the safety instructions. For safety reasons persons less than 16 years of age or people that are not familiar with these instructions should not use this equipment.

DESCRIPTION & FEATURES

YOUR PLATYPUS PUMP HAS BEEN MANUFACTURED WITH ADVANCED TECHNOLOGY TO PROVIDE YOU WITH THE BEST QUALITY PUMP FOR YOUR POND OR WATER FEATURE.

- Platypus pumps are suitable for use in many different applications including fountains, water features, small ponds and hydroponics.
- Your Platypus pump has a single moving part (an impellor set) therefore enabling easy cleaning and maintenance.
- The motor and electrical components are encapsulated in epoxy resin, ensuring safe operation under water.
- The pump has a robust bearing and shaft design so no oil/grease lubrication is required. Check out the Platypus range of pond lights and accessories.

INSTALLATION

1. If required, have a qualified electrician install weatherproof power point near to the pond or water feature, (within the cable length of the pump).
2. Place the pump in desired location, ensure it is on a stable surface free of sludge/debris and connect tubing to the outlet.
3. Ensure pump is submerged, then plug in power cord and switch on.

MAINTENANCE

- Disconnect power cord from the power supply before performing maintenance. Never lift the pump by the power cord.
- The only serviceable item is the impellor set.
- The motor unit of the pump is encapsulated with epoxy resin and does not need lubrication.
- All Platypus submersible pumps are water cooled; if pump becomes restricted it will overheat and could cause permanent damage. Ensure pump does not become blocked or restricted.

- The power cord cannot be replaced, if the cord is damaged, the pump must be discarded.
 - The complete vortex impellor set is a wearing consumable part. Regular inspections, cleaning and maintenance of impellor is necessary to ensure longer impellor life. If the vortex impellor becomes worn or damaged it should be replaced (available from your local dealer). failure to do so may cause serious damage to the pump.
1. Disconnect the power cord before performing maintenance.
 2. Remove from water and detach tubing.
 3. Remove front filter cage by gently squeezing sides.
 4. Unscrew the four large screws facing the rear of the motor and remove the impellor housing. Note: You do not need to remove impellor cover.
(Models: PP65, PP85, PP110, PP30, PP60)
 5. Remove the impellor cover by turning anticlockwise and pulling out (it may be quite stiff due to algae and grime build up. Gently remove the impellor and shaft, use long nose pliers if needed. Take care not to break ceramic shaft (if applicable) because they are brittle.
(Models: PP10LV, PP25LV, PP40LV, PP12, PP25, PP40)
 6. Gently remove O'Ring seal & impellor set. Clean the impellor & impellor chamber taking care not to damage or scour surfaces. Check for any signs of wear or damage.
 7. Reinstall the complete impellor set making sure the locator probe fits into the hole on the impellor set. Put the impellor set in firmly. Carefully replace O'ring seal. Check the impellor can spin freely. This step is important, ensure impellor is refitted correctly or the pump could be damaged. If unsure contact your dealer.
 8. Put impellor housing back on and screw the four screws back in, making sure the screws are done up evenly. Apply pressure to the impellor while replacing housing to ensure impellor remains locked in correct position.
 9. Replace front filter cage, re-attach tubing to outlet, submerge in water and turn on.

EXPLODED VIEW & PARTS

1. Front Cover
2. Biosponge
3. Intake Screen
4. Impellor Cover
5. Impellor
6. Motor Body
7. Extendable Riser
8. Bell Nozzle
9. Daisy Nozzle
10. Pump Adaptors
11. Inlet Adaptor*
12. Flow Controller with Waterfall Outlet
13. Flow Controller Adaptor



1. Front Cover
2. Biosponge
3. Intake Screen
4. Impellor Cover
5. Impellor
6. Motor Body
7. Extendable Riser
8. Bell Nozzle
9. Daisy Nozzle
10. Tubing Adaptors
11. Inlet Adaptor*
12. Flow Controller
13. AC Adaptor



SUBMERSIBLE PUMPS

INSTRUCTION MANUAL

1. Front Suction Screen*
2. Stepped Hosetail
3. Impellor Housing
4. Impellor
5. Motor Body

PP30 | PP60

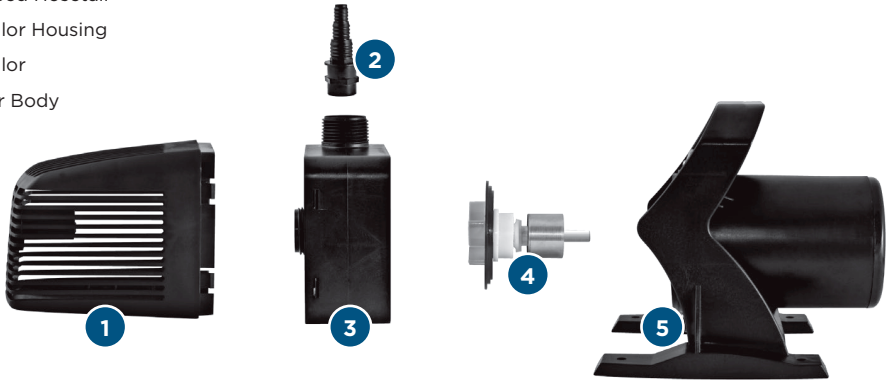

*This pump requires no prefilter sponge

1. Outer Filter Screen
2. Inner Filter Screen
3. Impellor Cover
4. Impellor
5. Motor Body
6. Stepped Outlet Hosetail

PP65 | PP85 | PP110



TROUBLESHOOTING

PROBLEM	REASON	SOLUTION
Water Pump Not Working	No Power	Check that the plug is connected and turned on
	Sponges and filter media blocked with sludge	Clean the sponges and filters
	Impellor is blocked with sludge or limescale	Clean the Impellor as per the instructions
	Running without sufficient water	Submerge the equipment underwater then plug in. Refill if necessary.
	Blocked Impellor chamber or ceramic shaft is broken	Clean the Impellor. Check for ware. Replace if necessary.
Water Pump is noisy	Blockage in pump	Clear the blockage
	Impellor & Shaft worn out	Replace Impellor & Shaft
	Impellor broken	Replace Impellor
	Water valve closed on the outlet	Open the valve and allow water to flow
	Unit inlet is blocked or the water pump inlet is blocked	Clear all blockages

SUBMERSIBLE PUMPS

INSTRUCTION MANUAL

IMPORTANT SAFEGUARDS

TO GUARD AGAINST INJURY, BASIC SAFETY PRECAUTIONS SHOULD BE OBSERVED INCLUDING, BUT NOT LIMITED TO:

- The pump should only be used in clean water. Do not use the pump in any solvent, gasoline that is flammable or hot water.
- Do not operate the pump without water at any time, permanent damage may occur.
- Do not operate the pump if the pump or any of the components of the pump, such as the power cable, have been damaged.
- The drip loop method should be used to prevent water from traveling down the cord onto the plug or power point. If the plug does get wet, do not unplug the cord. Disconnect the circuit breaker that supplies power to the power point. Then unplug and examine the plug and power point for presence of water. If the power point has become wet, you should consult an electrician before using the power point again.
- Always use a properly grounded power supply that is connected to an RCD with a rated residual operating current not exceeding 30mA. As per AS/NZS 3350.2.41:1997.
- Always unplug the pump from the power supply when not in use or before performing any maintenance on the pump. Never pull the cord to disconnect the plug from the power supply. Grasp the plug and pull to disconnect.
- Do not install or store the pump where it will be exposed to extreme hot or cold temperatures. Operating temperature 5°C to 36°C.
- Keep out of reach of children or pets. This appliance should not be used by children or infirm persons without supervision.
- Do not cut the cord as this will result in voiding your warranty.
- Care should be taken to arrange the power cord so that it cannot be accidentally tripped over or pulled.
- Do not attempt to repair the pump yourself. Return to an authorized service centre or place of purchase if a fault occurs.
- Do not use in water above 35°C.

LIMITED WARRANTY

WARRANTY COVERS ONLY APPLIANCE DEFECTS AND FAULTY MATERIAL AND WORKMANSHIP WITHIN A 2 YEAR PERIOD.

- Faults arising due to; accidents, misuse, not following manufacturer's guidelines/ instructions, or power surges/spikes/ brownouts will not be covered.
- The impellor set is a consumable item and is therefore not covered under warranty.
- Warranty will be void if any tampering, removal of warranty labels, or electrical circuitry is evident.
- Warranty will be void if the power cord is cut or damaged in any way.
- Warranty will be void if any visible signs of overheating are present.
- Loss of livestock, damage to property or personal injury caused by this product will not be covered.
- Warranty claims caused by installation faults will not be covered. It is the customer's responsibility to return the faulty appliance for any warranty claim, to Platypus.
- For any warranty to be valid, an original proof of purchase must be provided.
- Our goods come with guarantees that cannot be excluded under the Australian Consumer Law. You are entitled to a replacement or refund for a major failure and for compensation for any other reasonably foreseeable loss or damage. You are also entitled to have the goods repaired or replaced if the goods fail to be of acceptable quality and the failure does not amount to a major failure.



Platypus

Submersible Pumps



PO BOX 1042, KELMSCOTT WA 6997

TEL: 08 6244 4342

EMAIL: sales@viulighting.com